



### Common Mode Choke ET24 Series

#### ET24 Type 1



#### Dimensions:(mm)

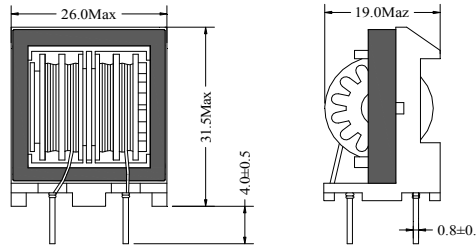

#### Schematic:

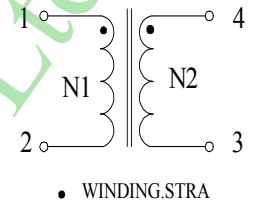

#### ET24 Type 2



#### Dimensions:(mm)

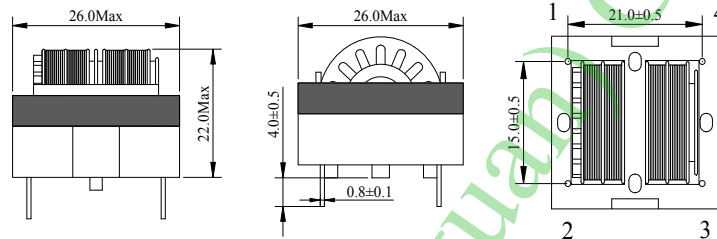

#### Schematic:

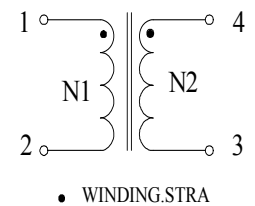

#### APPLICATIONS:

- EMC suppressors.
- AC line filter.

#### Feature:

- Line filters suppressing conductive noise ranging from low to high frequencies generated at power supply circuits of the various electronic equipment.
- High safety and reliability .
- Closed magnetic circuit.
- Easy PC board mounting.

#### ELECTRICAL CHARACTERISTICS:

Part Number	Inductance ( mH )Min	DCR Max.(OHM)	Rated Current (A) Max
PZ-ET24-2.4	2.4	0.09	2.5
PZ-ET24-3.3	3.3	0.11	2.00
PZ-ET24-3.9	3.9	0.15	1.80
PZ-ET24-4.5	4.5	0.19	1.50
PZ-ET24-10	10.0	0.38	1.20
PZ-ET24-20	20.0	0.64	1.00
PZ-ET24-25	25.0	0.88	0.80
PZ-ET24-33	33.0	1.20	0.60
PZ-ET24-45	45.0	1.65	0.50
PZ-ET24-68	68.0	2.30	0.40

★Due to the limited space, the catalogue shows the typical specifications only. For more Specific details ( characteristics graph, reliability, and others)

★Design to customer requirement

1.Test Frequency : 1KHZ/0.25V. Operating temperature : -50 °C to 130 °C

2.Rated Current:The current when temperature of coil increases up to Max.  $\Delta T=40^{\circ}C$  ( $T_a=20^{\circ}C$ )

3. Insulation: AC 2000V 1 minute between line & line

4.Insulation Resistance: 100 M $\Omega$  Min when DC 500V between line & line